

Coleman & Associates Land Surveying

G.P.S. Data Log Sheet

Job No. and Name: **09-1614 AUBREY BENCHMARK** Revision Date: **Oct. 11, 2010**
 County: **DENTON COUNTY** Survey, Abstract No.: **D. COWAN SY A-304**
 Latitude: **N 33 17 24.65032** Longitude: **W 96 59 26.19017**
 Antenna Type: **TRM 5800** Antenna height: **2M FIXED**

Control Point Name(s): LIBRARY	
Y - Northing: 7,155,634.66	X - Easting: 2,429,694.62
Datum: NAD83(CORS96)(EPOCH:2002.000)	Zone: SPC (4202TXNC)
Z - Elevation: ORTHO HEIGHT 676.28	Datum: NAVD88[COMPUTED USING GEOID 09]
Established from CORS Base Stations	LATITUDE LONGITUDE DISTANCE (m)
TXDE DENTON CORS ARP	N33 12 37.612 W97 09 45 .97 18319.7m
ZFW1 FORT WORTH WAAS 1 CORS ARP	N32 49 50.32 W97 03 59.262 51456.3m
TXCO COLLIN CORS ARP	N33 09 54.927 W96 37 40.571 36535.5m

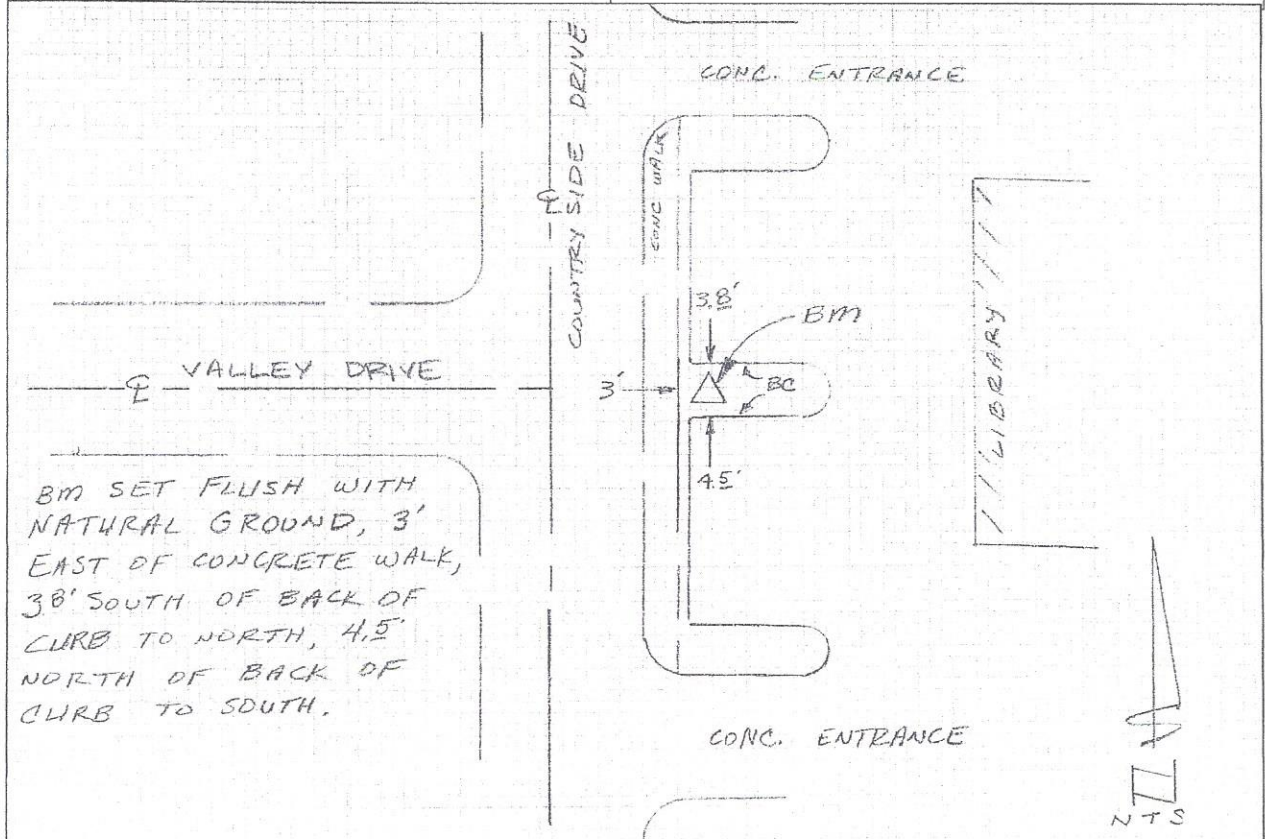

Andy Cox \ Approved By:

Date 10-11-10

Coleman & Associates Land Surveying

G.P.S. Data Log Sheet

Job No. and Name: **09-1614 AUBREY BENCHMARK** Revision Date: **Oct. 11, 2010**
County: **DENTON COUNTY** Survey, Abstract No.: **D. COWAN SY A-304**
Latitude: **N 33 18 14.82753** Longitude: **W 96 59 10.10191**
Antenna Type: **TRM 5800** Antenna height: **2M FIXED**

Control Point Name(s): TOWNHALL	
Y - Northing: 7,160,724.91	X - Easting: 2,430,986.95
Datum: NAD83(CORS96)(EPOCH:2002.000)	Zone: SPC (4202TXNC)
Z - Elevation: ORTHO HEIGHT 688.29	Datum: NAVD88[COMPUTED USING GEOID 09]
Established from CORS Base Stations	LATITUDE LONGITUDE DISTANCE (m)
TXDE DENTON CORS ARP	N33 12 37.612 W97 09 45.97 19463.7m
ZFWI FORT WORTH WAAS 1 CORS ARP	N32 49 50.32 W97 03 59.262 53045.2m
TXCO COLLIN CORS ARP	N33 09 54.927 W96 37 40.571 36768.2m

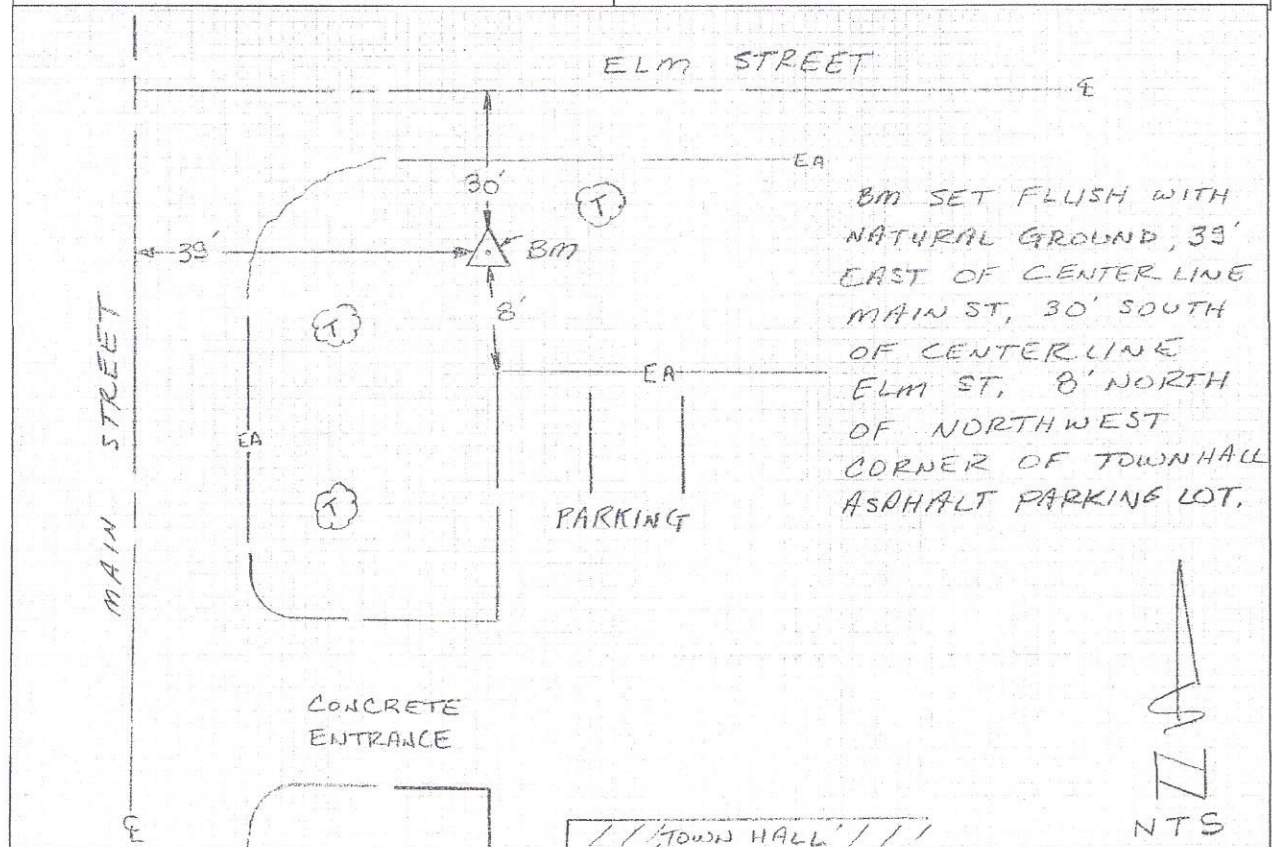

Andy Cox \ Approved By: _____

Date **10-11-10**